

Mathews Brothers  
Company

		DESCRIPTION: Classics New Construction Horizontal Single Slider (Left Vent from Exterior Shown)		
				DATE: October 28, 2019
SHEET:	DRAWN BY:	SCALE:		DWG NO.:

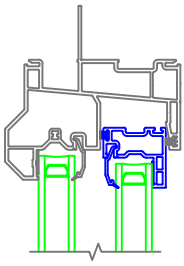

With J-Channel

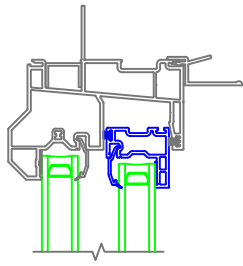

J-Channel Filler

1/2"-5/8"  
Drywall Return

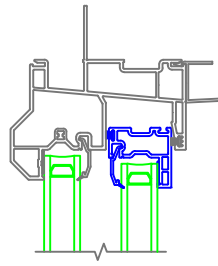

3/4"  
Drywall Return

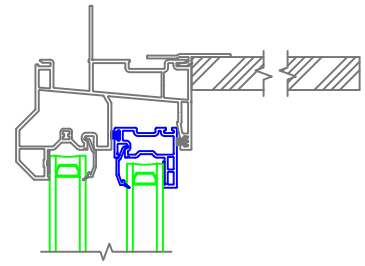

Extension Jamb

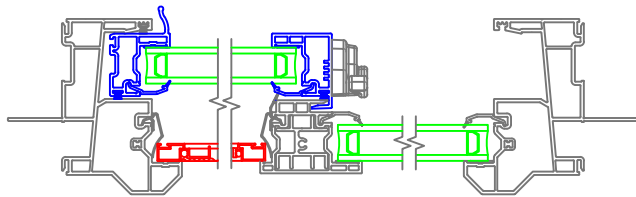

With J-Channel

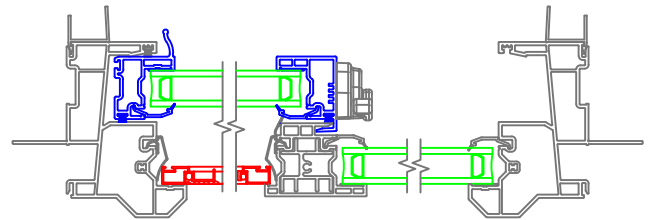

3/4"  
Drywall Return

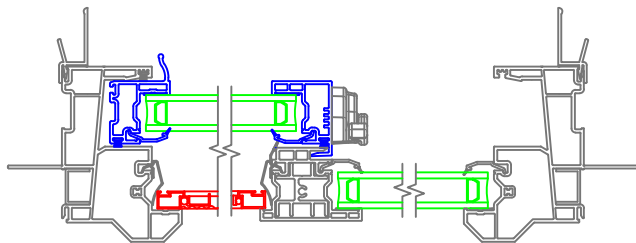

J-Channel Filler

1/2"-5/8"  
Drywall Return

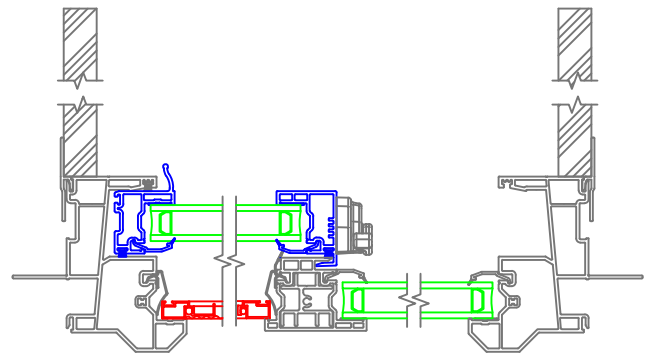

Extension Jamb

Mathews Brothers  
Company

DESCRIPTION:

Classics New Construction  
Horizontal Single Slider (Left Vent from Exterior Shown)

SHEET:

DRAWN BY:

SCALE:

1:4

DATE:

October 28, 2019

DWG NO.:

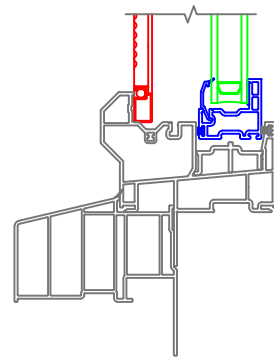
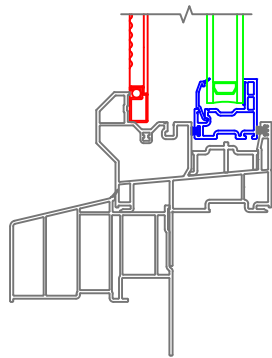
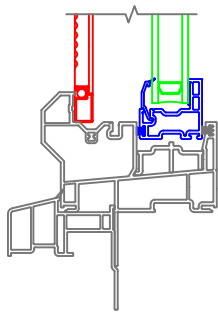
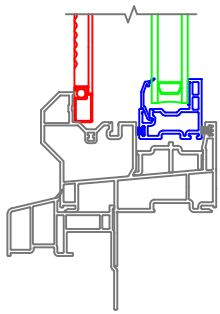
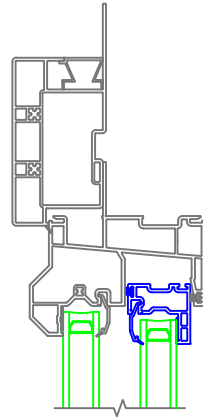
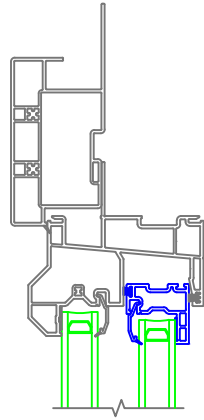
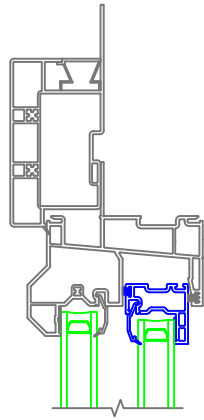
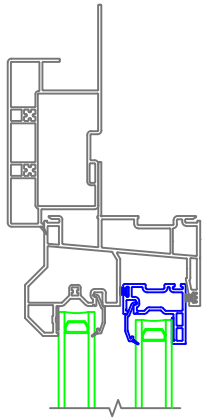

5/4 x 3-1/2 Flat Casing with J-Channel  
Standard Sill Nose

5/4 x 3-1/2 Flat Casing without J-Channel  
Standard Sill Nose

5/4 x 3-1/2 Flat Casing with J-Channel  
Historical Sill Nose

5/4 x 3-1/2 Flat Casing without J-Channel  
Historical Sill Nose

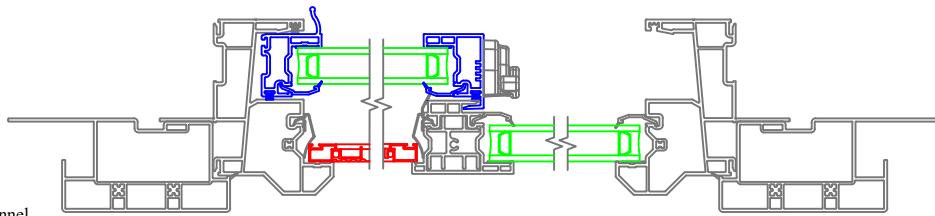

5/4 x 3-1/2 Flat Casing with J-Channel

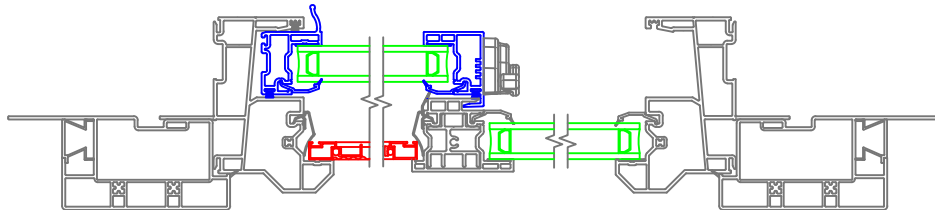

5/4 x 3-1/2 Flat Casing without J-Channel

Mathews Brothers  
Company

DESCRIPTION:

Classics New Construction  
Horizontal Single Slider (Left Vent from Exterior Shown)

SHEET:

DRAWN BY:

SCALE:

1:4

DATE:

October 28, 2019

DWG NO.:

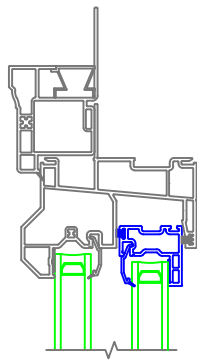
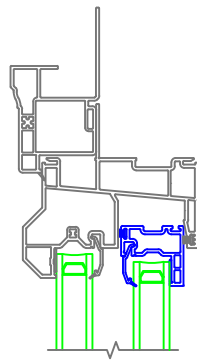
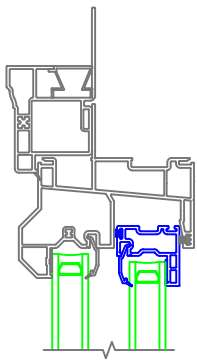
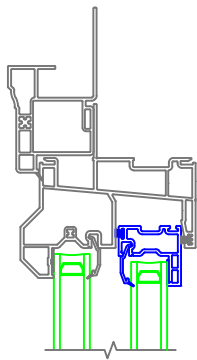

Brickmould Casing with J-Channel  
Standard Sill Nose

Brickmould Casing without J-Channel  
Standard Sill Nose

Brickmould Casing with J-Channel  
Historical Sill Nose

Brickmould Casing without J-Channel  
Historical Sill Nose

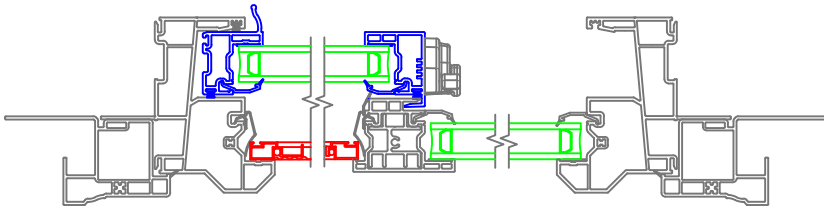

Brickmould Casing with J-Channel

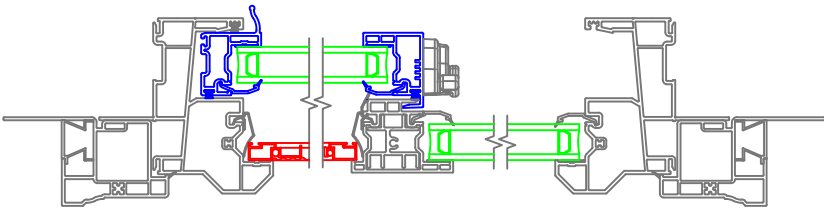

Brickmould Casing without J-Channel

Mathews Brothers  
Company

DESCRIPTION:			
Classics New Construction Horizontal Single Slider (Left Vent from Exterior Shown)			
SHEET:	DRAWN BY:	SCALE:	DATE: October 28, 2019
		1:4	DWG NO.:

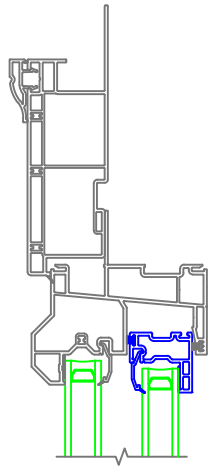

4-1/2 Banded Casing with J-Channel  
Standard Sill Nose

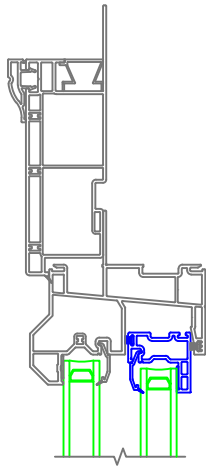

4-1/2 Banded Casing without J-Channel  
Standard Sill Nose

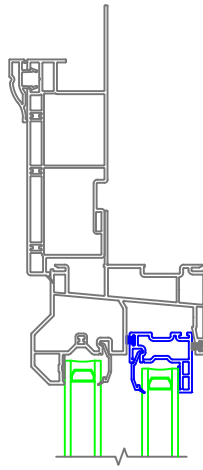

4-1/2 Banded Casing with J-Channel  
Historical Sill Nose

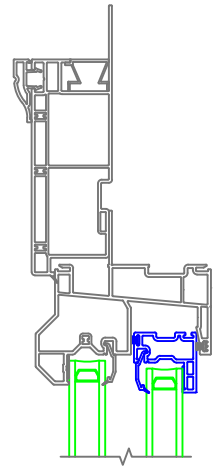

4-1/2 Banded Casing without J-Channel  
Historical Sill Nose

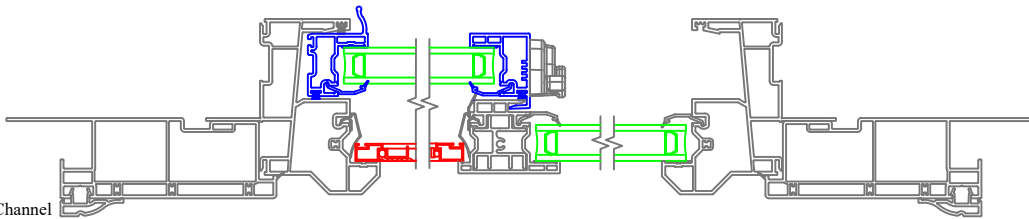
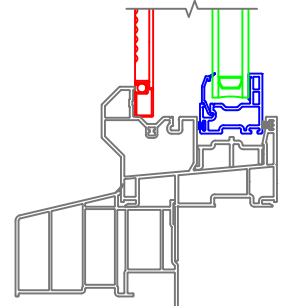
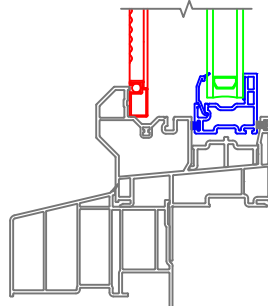
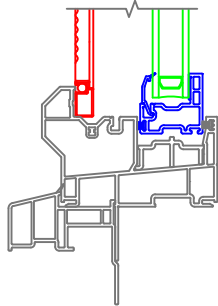
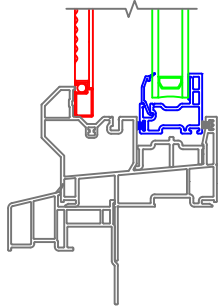

4-1/2 Banded Casing with J-Channel

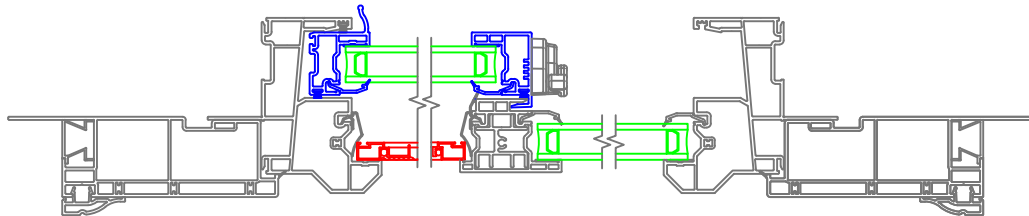

4-1/2 Banded Casing without J-Channel

Mathews Brothers  
Company

DESCRIPTION:

Classics New Construction  
Horizontal Single Slider (Left Vent from Exterior Shown)

SHEET:

DRAWN BY:

SCALE:

1:4

DATE:

October 28, 2019

DWG NO.:

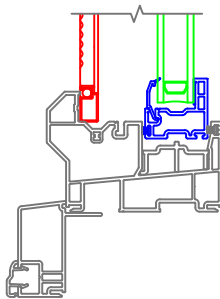
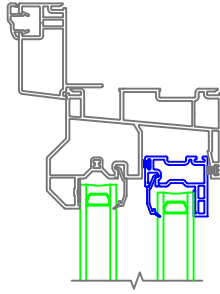

Northern Casing without J-Channel

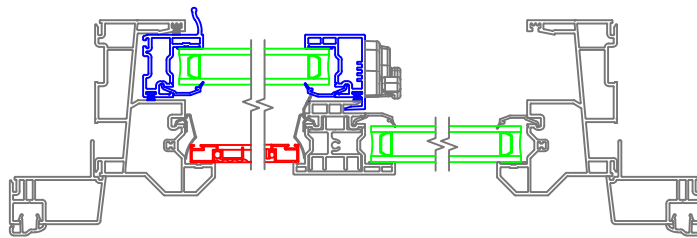

Northern Casing without J-Channel

Mathews Brothers  
Company

DESCRIPTION:

Classics New Construction  
Horizontal Single Slider (Left Vent from Exterior Shown)

SHEET:

DRAWN BY:

SCALE:

1:4

DATE:

October 28, 2019

DWG NO.:

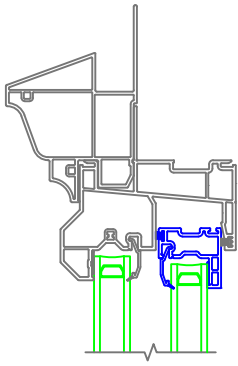

With J-Channel and Crown Crosshead Moulding

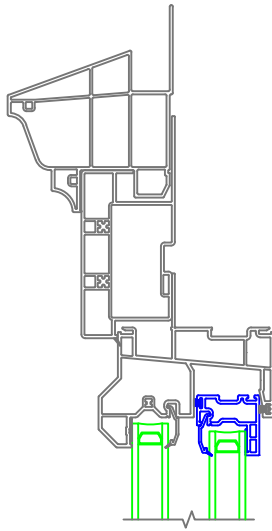

5/4 x 3-1/2 Flat Casing and Crown Crosshead Moulding

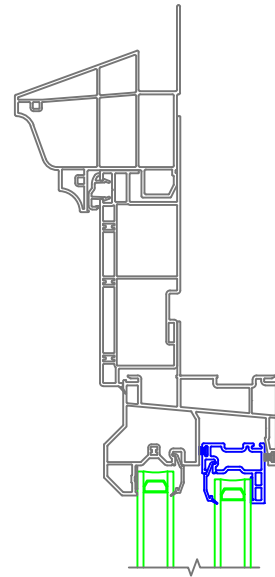

4-1/2 Banded Casing and Crown Crosshead Moulding

Grille in Airspace and Simulated Divided Lite Options

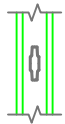

Contour

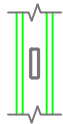

Rectangle, 5/8"



7/8" SDL  
with Spacer



7/8" SDL  
without Spacer



5/8" SDL  
with Spacer

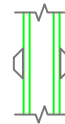

5/8" SDL  
without Spacer

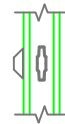

5/8" Exterior SDL  
with Contour



1-3/8" SDL

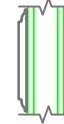

2-1/8" SDL

Mathews Brothers  
Company

DESCRIPTION:

Classics New Construction  
Horizontal Single Slider (Left Vent from Exterior Shown)

SHEET:

DRAWN BY:

SCALE:

1:4

DATE:

October 28, 2019

DWG NO.:

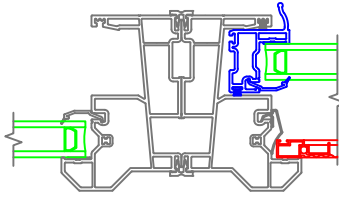

Narrow Mull

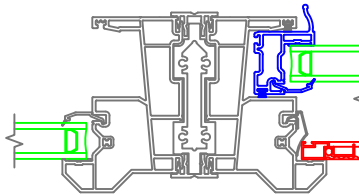

$\frac{1}{2}$ " Aluminum Reinforced

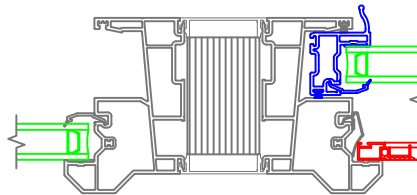

Solid Spread Mull

Mathews Brothers  
Company

DESCRIPTION:

Classics New Construction  
Horizontal Single Slider (Left Vent from Exterior Shown)

SHEET:

DRAWN BY:

SCALE:

1:4

DATE:

October 28, 2019

DWG NO.: