

Mathews Brothers  
Company

--	--	--	--	--

		DESCRIPTION: Walcott New Construction Direct Glaze Transom		
"A"				DATE: May 10, 2018
SHEET:	DRAWN BY:	SCALE:		DWG NO.:

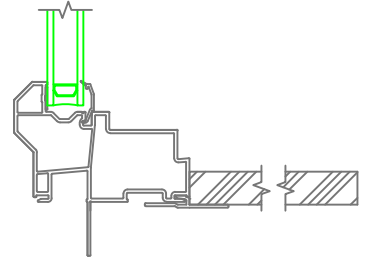
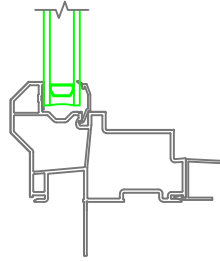
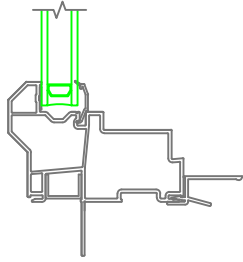
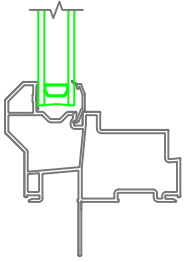
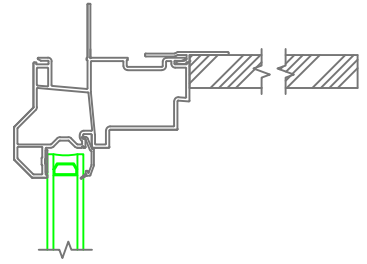
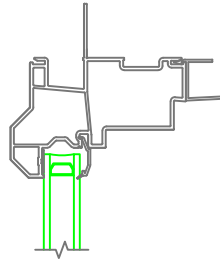
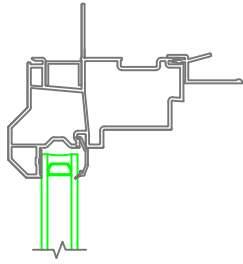
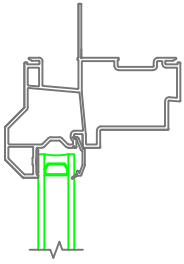

With J-Channel

J-Channel Filler  
1/2"-5/8"  
Drywall Return

3/4"  
Drywall Return

Extension Jamb

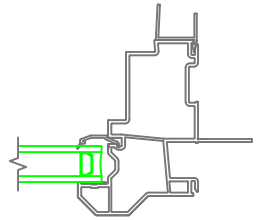
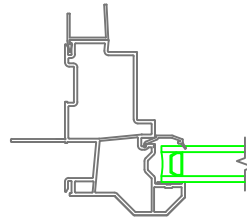
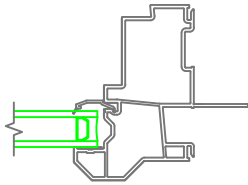
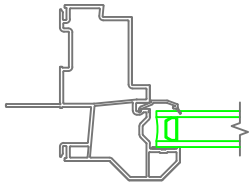

With J-Channel

3/4"  
Drywall Return

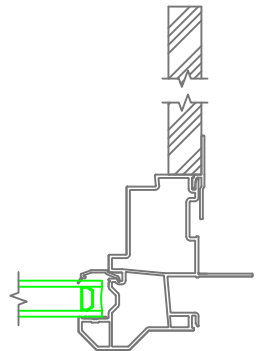
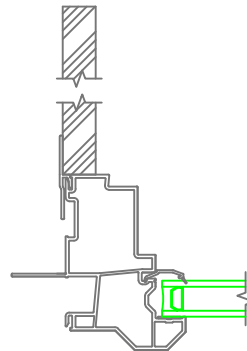
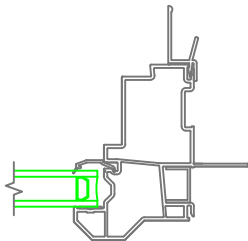
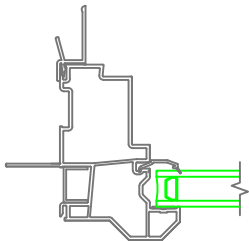

J-Channel Filler

1/2"-5/8"  
Drywall Return

Extension Jamb

Mathews Brothers  
Company

DESCRIPTION:

Walcott New Construction  
Direct Glaze Transom

"A"

SHEET:

DRAWN BY:

SCALE:

1:4

DATE:

May 10, 2018

DWG NO.:

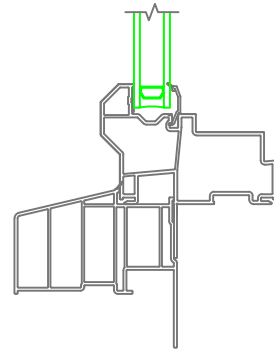
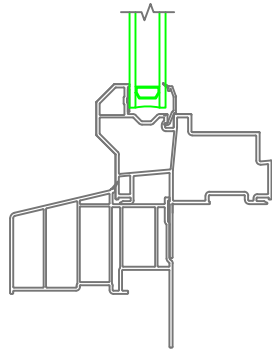
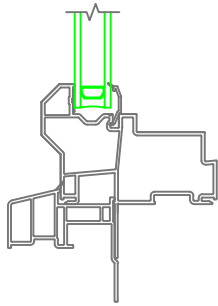
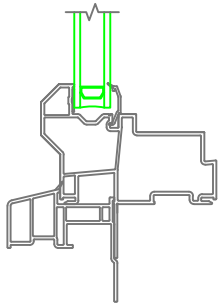
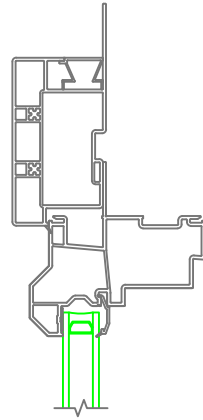
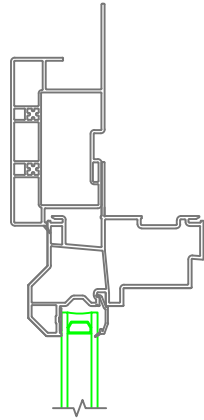
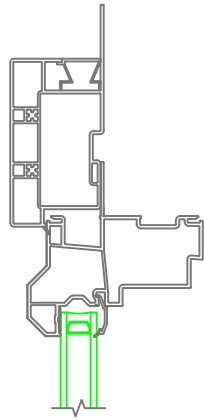
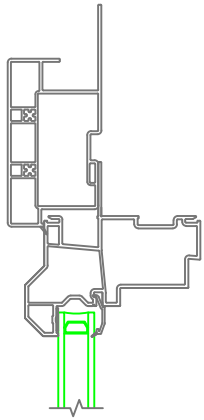

5/4 x 3-1/2 Flat Casing with J-Channel  
Standard Sill Nose

5/4 x 3-1/2 Flat Casing without J-Channel  
Standard Sill Nose

5/4 x 3-1/2 Flat Casing with J-Channel  
Historical Sill Nose

5/4 x 3-1/2 Flat Casing without J-Channel  
Historical Sill Nose

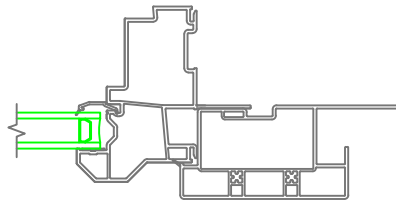
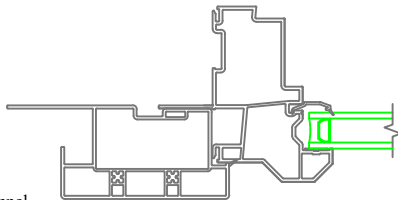

5/4 x 3-1/2 Flat Casing with J-Channel

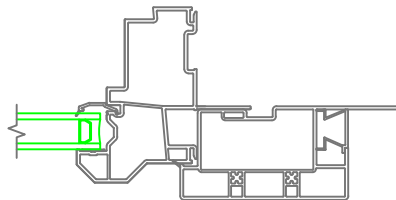
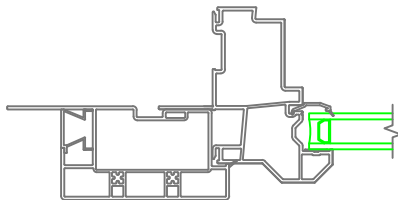

5/4 x 3-1/2 Flat Casing without J-Channel

Mathews Brothers  
Company

DESCRIPTION:

Walcott New Construction  
Direct Glaze Transom

"A"

SHEET:

DRAWN BY:

SCALE:

1:4

DATE:

May 10, 2018

DWG NO.:

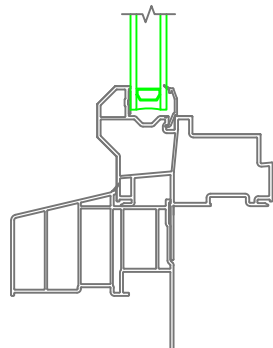
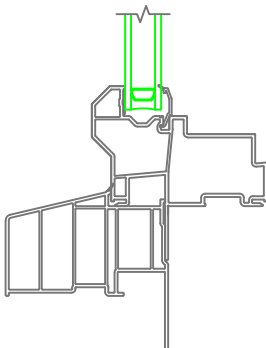
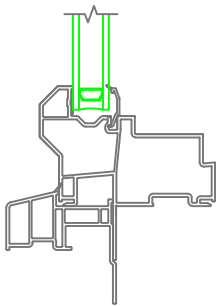
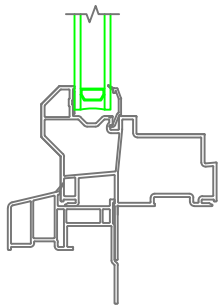
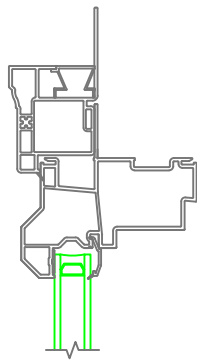
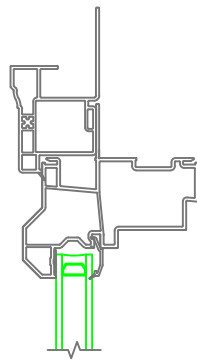
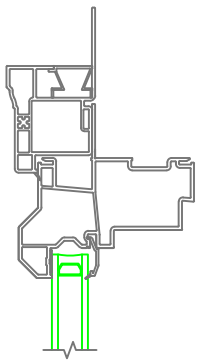
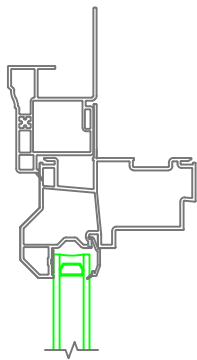

Brickmould Casing with J-Channel  
Standard Sill Nose

Brickmould Casing without J-Channel  
Standard Sill Nose

Brickmould Casing with J-Channel  
Historical Sill Nose

Brickmould Casing without J-Channel  
Historical Sill Nose

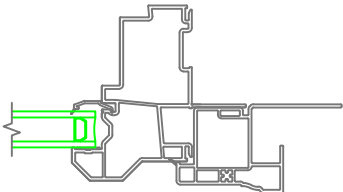
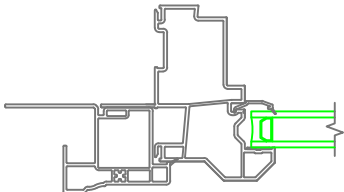

Brickmould Casing with J-Channel

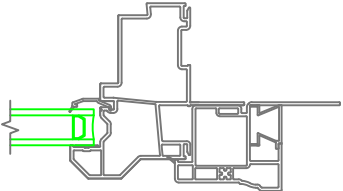
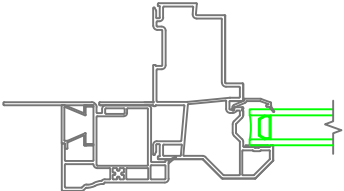

Brickmould Casing without J-Channel

Mathews Brothers  
Company

DESCRIPTION:		Walcott New Construction Direct Glaze Transom	
"A"	DRAWN BY:	SCALE:	DATE: May 10, 2018
SHEET:		1:4	DWG NO.:

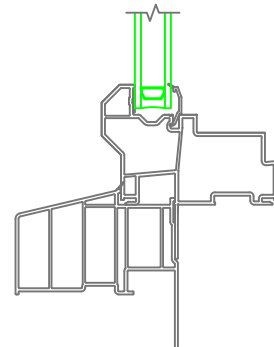
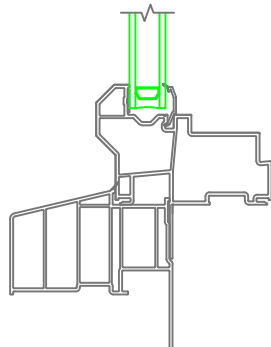
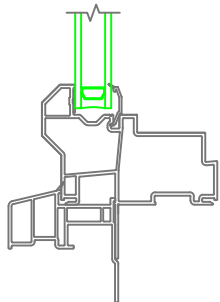
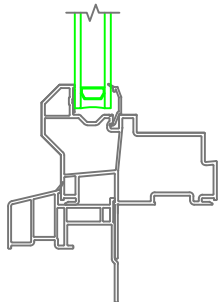
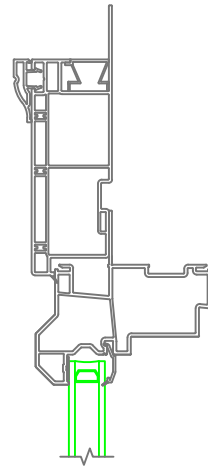
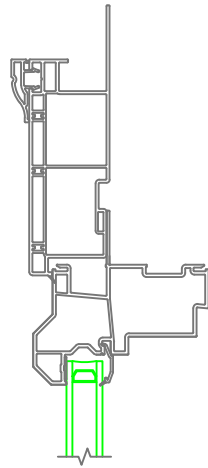
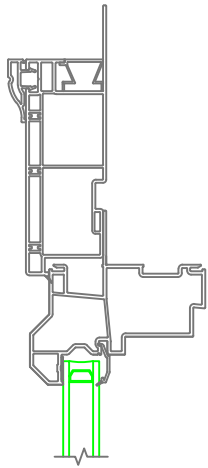
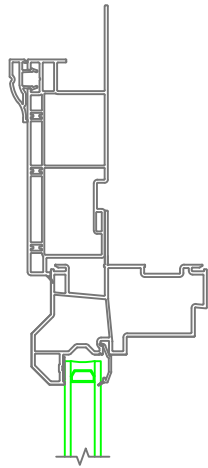

4-1/2 Banded Casing with J-Channel  
Standard Sill Nose

4-1/2 Banded Casing without J-Channel  
Standard Sill Nose

4-1/2 Banded Casing with J-Channel  
Historical Sill Nose

4-1/2 Banded Casing without J-Channel  
Historical Sill Nose

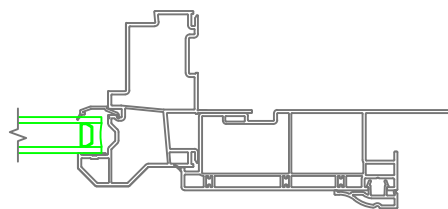
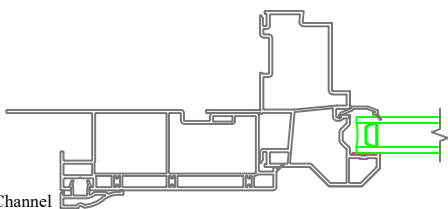

4-1/2 Banded Casing with J-Channel

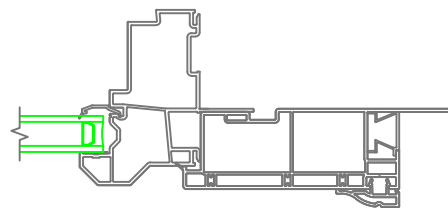
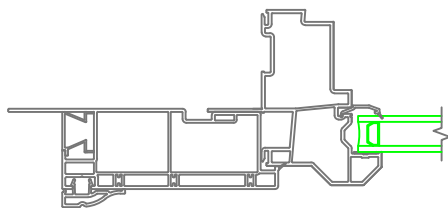

4-1/2 Banded Casing without J-Channel

Mathews Brothers  
Company

DESCRIPTION:

Walcott New Construction  
Direct Glaze Transom

"A"

SHEET:

DRAWN BY:

SCALE:

1:4

DATE:

May 10, 2018

DWG NO.:

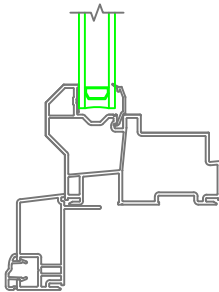
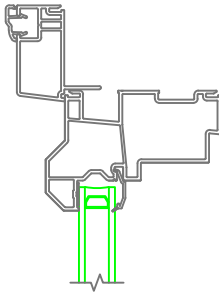

Northern Casing without J-Channel

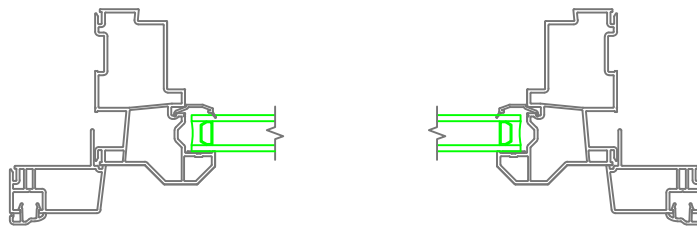

Northern Casing without J-Channel

Mathews Brothers  
Company

DESCRIPTION:				
Walcott New Construction Direct Glaze Transom				
"A"				DATE: May 10, 2018
SHEET:	DRAWN BY:	SCALE: 1:4		DWG NO.:

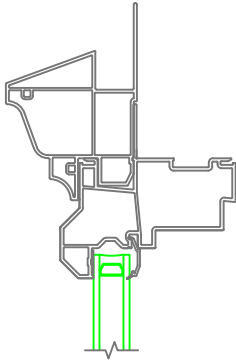

With J-Channel and Crown Crosshead Moulding

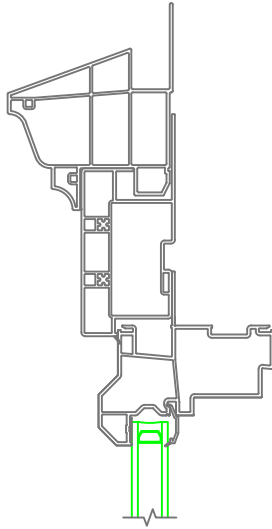

5/4 x 3-1/2 Flat Casing and Crown Crosshead Moulding

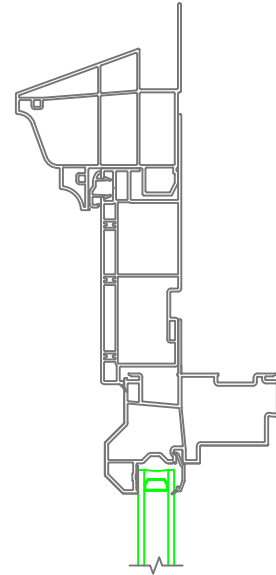

4-1/2 Banded Casing and Crown Crosshead Moulding

Grille in Airspace and Simulated Divided Lite Options

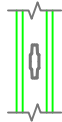

Contour



Rectangle, 5/8"



7/8" SDL  
with Spacer

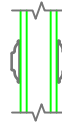

7/8" SDL  
without Spacer



5/8" SDL  
with Spacer

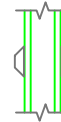

5/8" SDL  
without Spacer



5/8" Exterior SDL  
with Contour

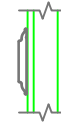

1-3/8" SDL

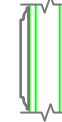

2-1/8" SDL

Mathews Brothers  
Company

DESCRIPTION:

Walcott New Construction  
Direct Glaze Transom

"A"				DATE: May 10, 2018
SHEET:	DRAWN BY:	SCALE: 1:4		DWG NO.: